



**4K**  
**ULTRA HD**

4K UHD / PCAP Touch Technology / Optical Bonding

# I32ZI-OQ-45PG

## LARGE FORMAT



The GVision I32ZI is a state-of-the-art 32-inch **4K** digital signage touchscreen monitor, enhanced with **Full Optical Bonding** technology. It boasts dual input options through **HDMI** and **DisplayPort**, providing seamless connectivity. With its cutting-edge **10-point PCAP** touchscreen technology, this monitor offers precise and responsive interactions. Encased in a robust industrial-grade all-metal chassis, it is designed to thrive in rugged environments.

-   
**4K**  
**ULTRA HD**  
 3840 x 2160  
 UHD
-   
 PCAP Touch  
 Technology
-   
**2x HDMI** Digital  
 Input
-   
**2x DisplayPort**  
 Input
-   
**350 nits**  
 Brightness
-   
 Full  
**Optical Bonding**
-   
 Horz/Vert  
 Display
-   
**3000:1**  
 Contrast Ratio
-   
 All Metal  
 Chassis
-   
**3**  
 YEAR  
 Warranty

32" / 4K UHD / 2x HDMI 2x DP / PCAP Touch

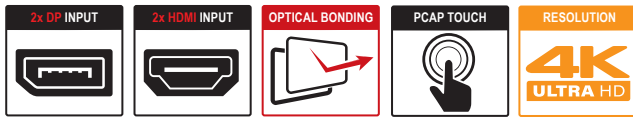

## FEATURES

- 32-Inch Screen Size / 4K UHD 3840 x 2160 Resolution
- 350 nits High Brightness / 3000:1 Contrast Ratio
- 10-Point Projected Capacitive PCAP Touch Technology
- Full **Optical Bonding**
- **Portrait and Landscape** Display
- Interface: **2x HDMI / 2x DisplayPort (DP) / Audio**
- **3-Year** Warranty

## SPECIFICATIONS



DISPLAY	I32ZI-OQ-45PG
Screen Size	32 In
Resolution	3840 x 2160
Backlight	LED
Aspect Ratio	16 : 9
Viewing Angle	178° / 178°
Response Time	9.5ms
Brightness	350cd/m <sup>2</sup>
Contrast Ratio	3000 : 1
Color Depth	16.7 M
INTERFACE	
HDMI	2
DisplayPort (DP)	2
Audio	1
USB Type-B	1
TOUCH TECHNOLOGY	
Material (Glass)	3mm Strengthen Glass
Type	Projected Capacitive (PCAP)
Points	10 MAX (Dependant on OS / Browser / Software)
Accuracy	2mm
Touch Response Time	10ms (typ)
Surface Durability	Mohs' 7H
Touch Activation Force	10g
Light Transmission	86%
FEATURES	
<b>Optical Bonding</b>	<b>Yes / Full Optical Bonding</b>
CABINET	
Material	Metal
POWER	
Input Voltage	12V DC +/- 5%
Electrical Ratings	AC 100V ~ 240V, 50/60Hz
TEMPERATURE	
Operating	32° F ~ 104° F (0° C ~ 40° C)
DIMENSIONS (WxHxD)	
Inch (in)	29.5 x 17.8 x 2.2
Millimeter (mm)	750.4 x 452.7 x 56.5
WEIGHT	
Net Weight	30.8 lbs (14 kg)
VESA™	
Mount Size (mm)	200 x 200

Specifications subject to change without any notice

## INTERFACE & OSD

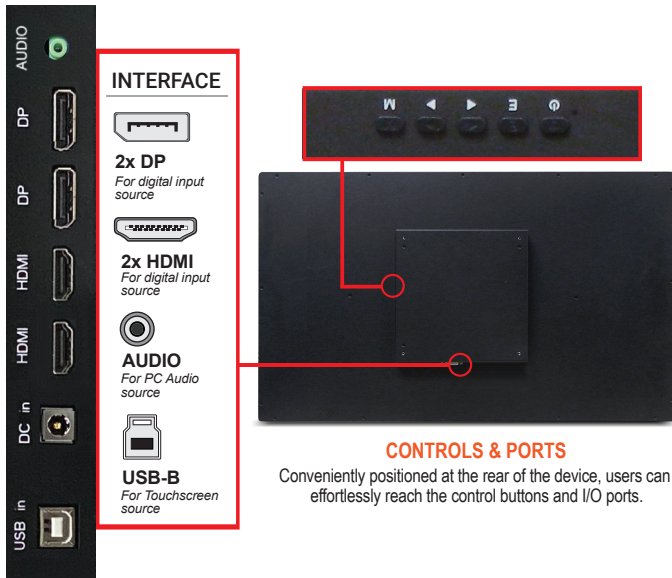

## DIMENSIONS

Unit: Inch

